



testo 6740

Instruction manual

GB



Preface/Copyright

Preface

Dear Testo Customer

Congratulations for choosing a Testo product. We hope that you will enjoy many years of using the product and that it will help you in your work.

If problems should occur which you cannot rectify yourself, please consult our service department or your dealer. We will endeavour to provide fast and competent assistance to save you long periods out of operation.

Copyright

This documentation is subject to the copyright of Testo AG. Reproduction and employment contrary to the justified interests of Testo AG are prohibited without the prior, written consent of the company.

We reserve the right to modify technical details from the descriptions, specifications and illustrations contained in this documentation.

testo AG

Postfach 11 40
79849 Lenzkirch
Germany

General information

This Instruction manual contains important information about the features and use of the product. Please read this document through carefully and familiarise yourself with the operation of the product before putting it to use. Keep the Instruction manual to hand so that you can refer to it when necessary.

Pictograms

This product could be dangerous if operated incorrectly. Information that requires particular attention is identified in this Instruction manual by pictograms:

Warnings are identified by means of a warning triangle. The relevant **signal word!** indicates the degree of risk:



Warning! means: Serious physical injury could occur if you do not take the precautionary measures indicated.

Caution! means: Slight physical injury or material damage could occur if you do not take the precautionary measures indicated.

Signal word! Pay particular attention to warnings and take the precautionary measures indicated in order to avoid danger.

! Notes on special cases and peculiarities in the handling of the product are indicated by an exclamation mark.

Standards/Approvals



According to the conformity certificate, this product fulfills all 89/336/EEC guidelines.

Contents

Preface/ Copyright	2
General information	3
Contents.....	4
1. Basic safety information	5
2. Intended use	6
3. Product description	7
3.1 System components	7
3.2 Operating elements	7
3.3 Settings	8
4. Initial operation	9
4.1 Mechanical assembly	9
4.2 Electric connection	10
4.3 Analog output/Limit signal outputs	12
5. Menu guide (0555.6743/0555.6744 only)	14
6. Adjustment on site	16
7. Care and maintenance	17
8. Troubleshooting	18
9. Technical data	19
9.1 Measurement ranges and accuracies	19
9.2 Additional instrument data	19
10. Accessories/Spare parts	20
Warranty	21
Customer service/Calibration service	22
Notes	23
Testo worldwide	26

1. Basic safety information



Avoid electrical hazards:

- ▶ Never take measurements with the instrument and its probes on or near live components unless the instrument is expressly approved for current and voltage measurements.



Protect the instrument:

- ▶ Never store the unit together with solvents (e.g. acetone).



Preserving product safety/warranty entitlement:

- ▶ Operate the instrument only within the parameters specified in the Technical data.
- ▶ Handle the instrument appropriately and according to its intended purpose.
- ▶ Never apply force!
- ▶ Temperature data on sensors/probes refer only to the measurement range of the sensors. Do not subject handles and lines to temperatures greater than 70°C if they are not expressly approved for higher temperatures.
- ▶ Open the instrument for maintenance and repair purposes only if specifically described in the Instruction Manual.
- ▶ Maintenance work should only be carried out if described in the Instruction Manual. Please adhere to the steps described. For safety reasons, please only use spare parts from Testo.

Any additional work should only be carried out by authorised trained personnel. Otherwise Testo does not accept responsibility for the functioning of the instrument following maintenance and for the validity of approvals.



Dispose of carefully:

- ▶ Dispose of defect rechargeable batteries as well as empty batteries responsibly.
- ▶ Once its service life has come to an end, return the instrument to us and we will dispose of it.

2. Intended use

The instrument is intended for use in the following applications:

The testo 6740 instrument is a pressure dew point transmitter for measuring trace humidity. It is used in the following areas:

- Monitoring trace humidity in compressed air systems and gas networks (e.g. pipeline and container drying).
- Controlling and monitoring (compressed air) driers.
- Monitoring compressed air humidity in vehicles.
- Monitoring humidity and temperature in medical compressed air or granulate driers.

3. Product description

3.1 System components

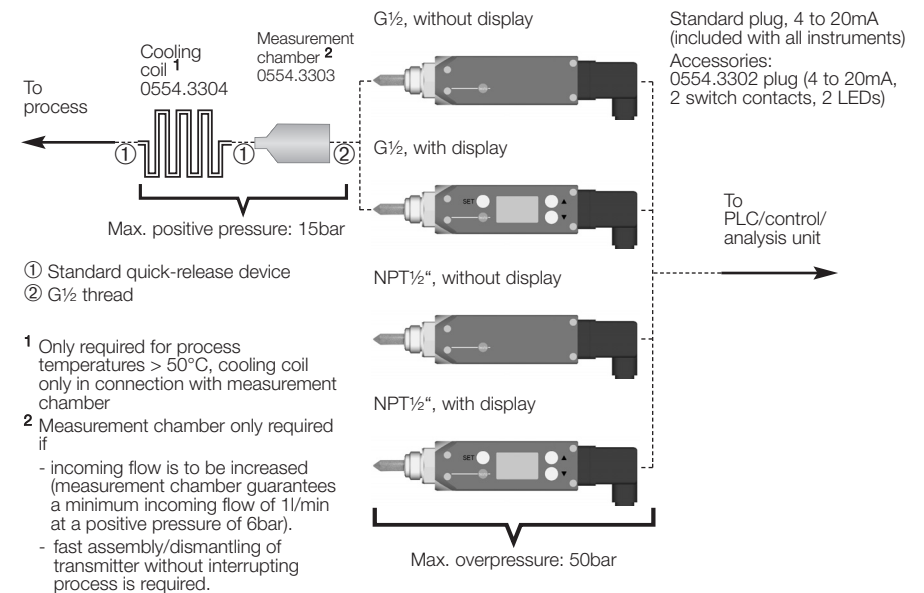

3.2 Operating elements

The instruments with the article numbers 0555.6741 and 0555.6742 do not have any additional operating elements.

The instruments with the article numbers 0555.6743 and 0555.6744 have a keypad and a display to input and read off settings (See 5. Menu guide, p. 12).

3.3 Settings

The parameters in the instrument are assigned the following values in the factory:

Parameter	Pressure dew point ¹		Atmospheric dew point ¹		Relative humidity	Temperature		Absolute humidity	
	°Ctp	°Ftp	°CtA	°FtA		°C	°F	ppm _v	mg/m ³ (Abs)
4mA	-60	-75	-60	-75	0	0	32	0	0
20mA	30	85	30	85	100	50	120	30000 ²	30000 ²
LS	4	40	4	40	30	10	50	8400	7000
US	12	55	12	55	50	30	85	13000	9600

¹ With dew point temperatures <0°Ctp / <0°CtA / <32°Ftp / <32°FtA the frostpoint temperature (dewpoint upon ice) is displayed

² Display is shown to the power of ten: 30E3 (corresponds to $30 \times 10^3 = 30 \times 1000 = 30000$)

4. Initial operation

4.1 Mechanical assembly

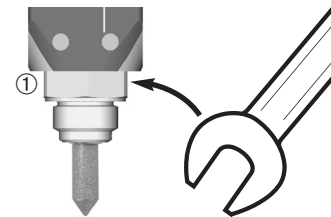

We recommend you wrap the thread of the process connection in sealing tape (e.g. Teflon) or place it in a copper gasket (inner diameter: 21mm).

► Force should only be applied to the Allen screw ①. There are 3 different options for assembly depending on the application:

Assembly	Application
Without measurement chamber and cooling coil	<ul style="list-style-type: none"> Process temperatures 0 to 50°C It is possible to attach sensor directly in process No quick assembly/dismantling of testo 6740 required and flow on sensor is sufficient (1l/min)
With measurement chamber	<ul style="list-style-type: none"> Process temperatures 0 to 50°C Fast assembly/dismantling of testo 6740 required and/or flow on sensor is insufficient (1l/min)
With measurement chamber and cooling coil	<ul style="list-style-type: none"> Process temperatures 50 to 200°C

Without measurement chamber and cooling coil



Warning

Compressed air!

Risk of injury!

► Depressurise pipe sections (e.g. compressor off or use bypass) and aerate before opening.

1 Screw process connection (G1/2 or NPT1/2") into the matching thread.

The housing can be rotated by 350°. Do not use force when aligning.

2 Set up housing so that the display can be easily read.

3 Complete aeration of pipe section and apply pressure to pipe section.

With measurement chamber (max. 15bar)

- 1 Screw in process connection (G $\frac{1}{2}$) of the testo 6741/6743 transmitter in measurement chamber thread.
- 2 Snap quick-release lock of measurement chamber in standard socket of compressed air line.

With measurement chamber and cooling coil (max. 15bar)

- 1 Screw in process connection (G $\frac{1}{2}$) of testo 6741/6743 transmitter into thread of measurement chamber.
- 2 Snap quick-release lock of measurement chamber in the quick-release lock of the cooling coil.
- 3 Snap second quick-release lock of the cooling coil into the standard socket of the compressed air line.

4.2 Electric connection

Standard plug

We recommend an 8 wire cable with a tightly braided screen and a core cross-section of 0.2 to 0.5mm².

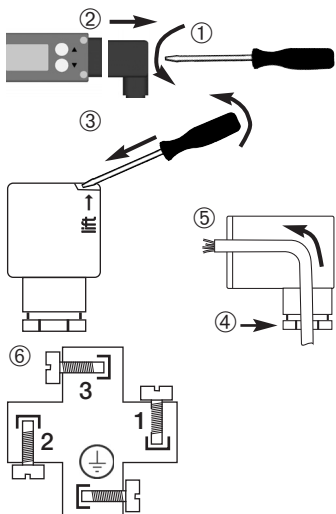

- 1 Loosen and remove ① screw at the back of the plug and remove plug from transmitter ②.
- 2 Remove plug socket from the plug housing. To do this apply a small screwdriver to the point marked with "lift" and press out carefully ③.
- 3 Screw on the cable positioning device ④ and guide the cables through the plug housing ⑤.
- 4 Connect cable ends to the screw terminals of the plug socket ⑥:

Plug socket terminals

- 1: + (4 to 20mA), power: 12...30VDC
- 2: - (4 to 20mA)
- 3: Not assigned
- 4: Measuring earth (cable screen)

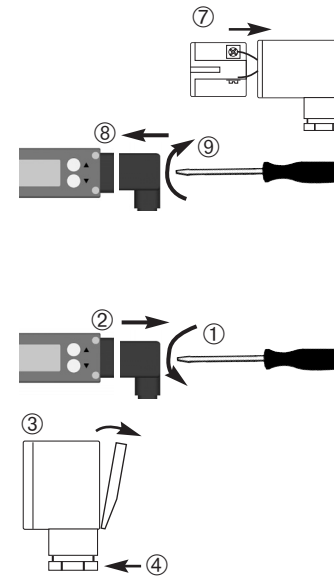

- 5 Insert plug socket into plug housing again until it snaps into place ⑦ and screw on cable fixing unit.
- 6 Attach plug to transmitter ⑧ and secure with screw ⑨.

0554.3302 plug (with 2 switch outputs)

We recommend an 8 wire cable with a tightly braided screen.

- 1 Loosen and remove screw ① at the back of the plug and remove plug from transmitter ②.
- 2 Tilt the cover of the plug housing at an angle and remove ③.
- 3 Remove plug socket from the front and the relay board from the back out of the plug housing.
- 4 Screw on cable positioning device ④ and guide cables through the plug housing.
- 5 Connect cable ends to the screw terminals of the relay board or the plug socket ⑤:

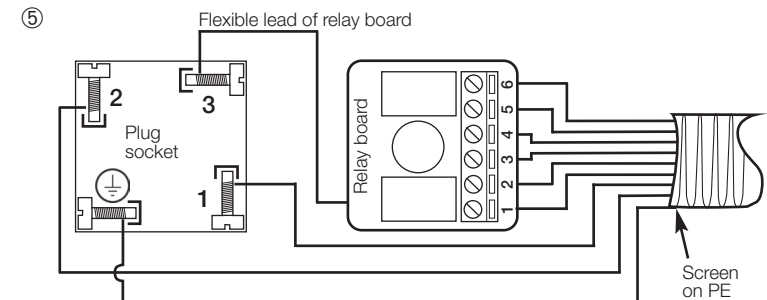

The supply lines need to be galvanically connected, so connect either (A) - (A) or (B) - (B)!

Plug socket terminals

- 1: I+ (4 to 20mA) (A)
- 2: I- (4 to 20mA) (B)
- 3: (connected to relay board in factory)
- ⊥: Put on screen

Relay board terminals

- 1: 20 to 28VDC (A)
- 2: LS+
- 3: LS-
- 4: US+
- 5: US-
- 6: 0VDC (B)

- 6 Push plug socket and plug board into the plug housing (pay attention to alignment) and close lid.
- 7 Screw on cable positioning device.
- 8 Attach plug to transmitter ⑥ and screw into place ⑦.

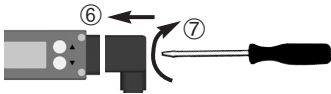

4.3 Analog output/Limit signal outputs

Standard plug/0554.3302 plug

Both plug variations have a 4 to 20mA analog output available in two-wire technology.

x,y connection:

Connection	Standard	0554.3302
x	Terminal 1	Terminal 1
y	Terminal 2	Terminal 6



Max. load R_L (external load):

U	Standard	0554.3302
12V	50 Ohm	–
24V	650 Ohm	650 Ohm
30V	950 Ohm	–

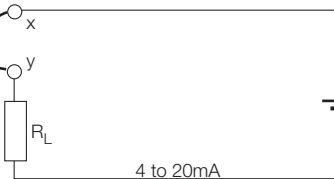

Power

Standard plug:
U = 12 to 30VDC
0554.3302 plug:
U = 20 to 28VDC

Limit signal outputs with 0554.3302 plug

Two floating contacts (NO contact) are available.

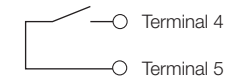
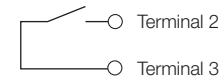
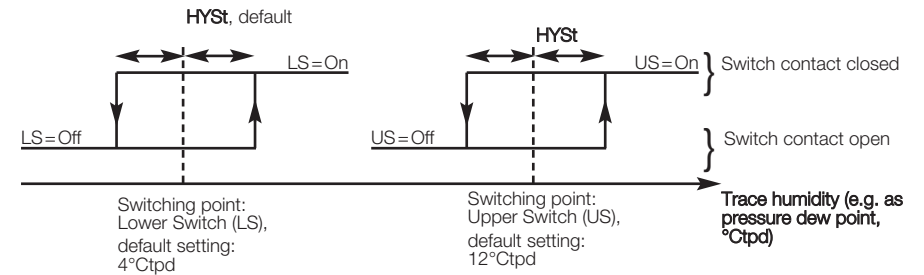





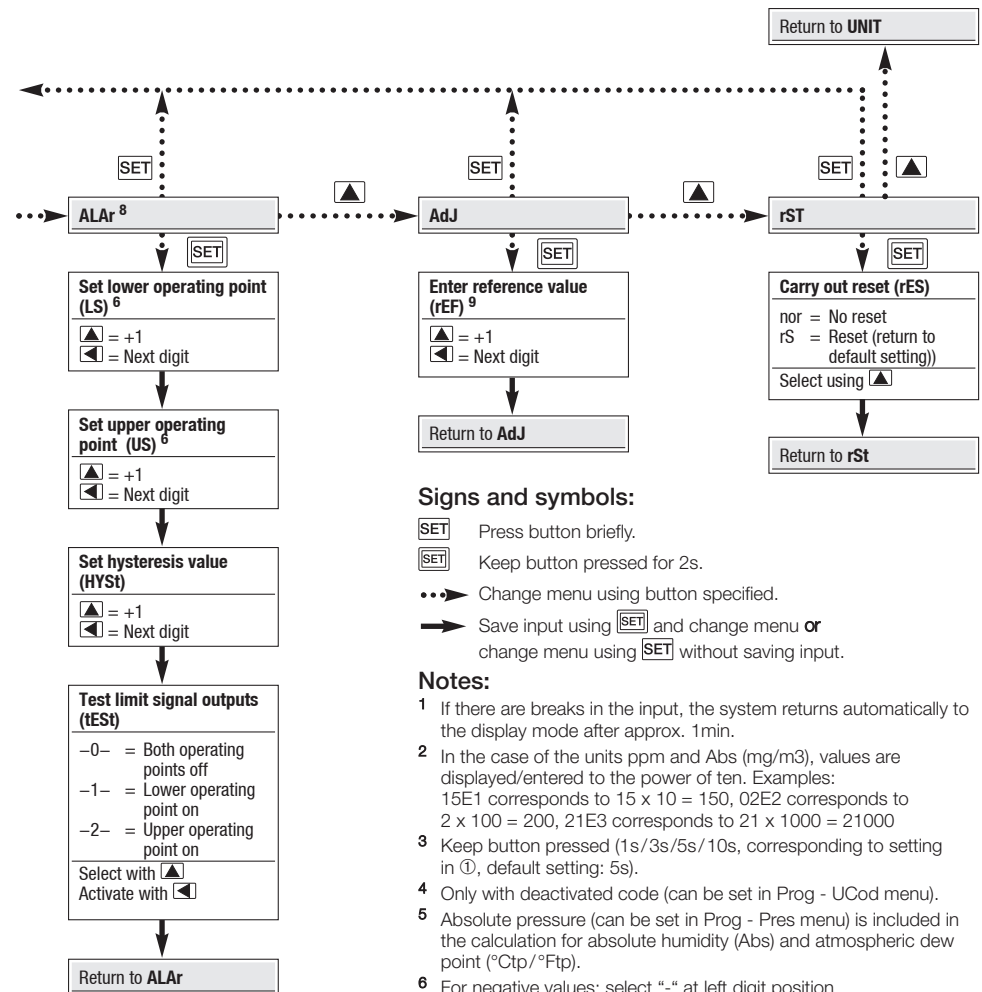
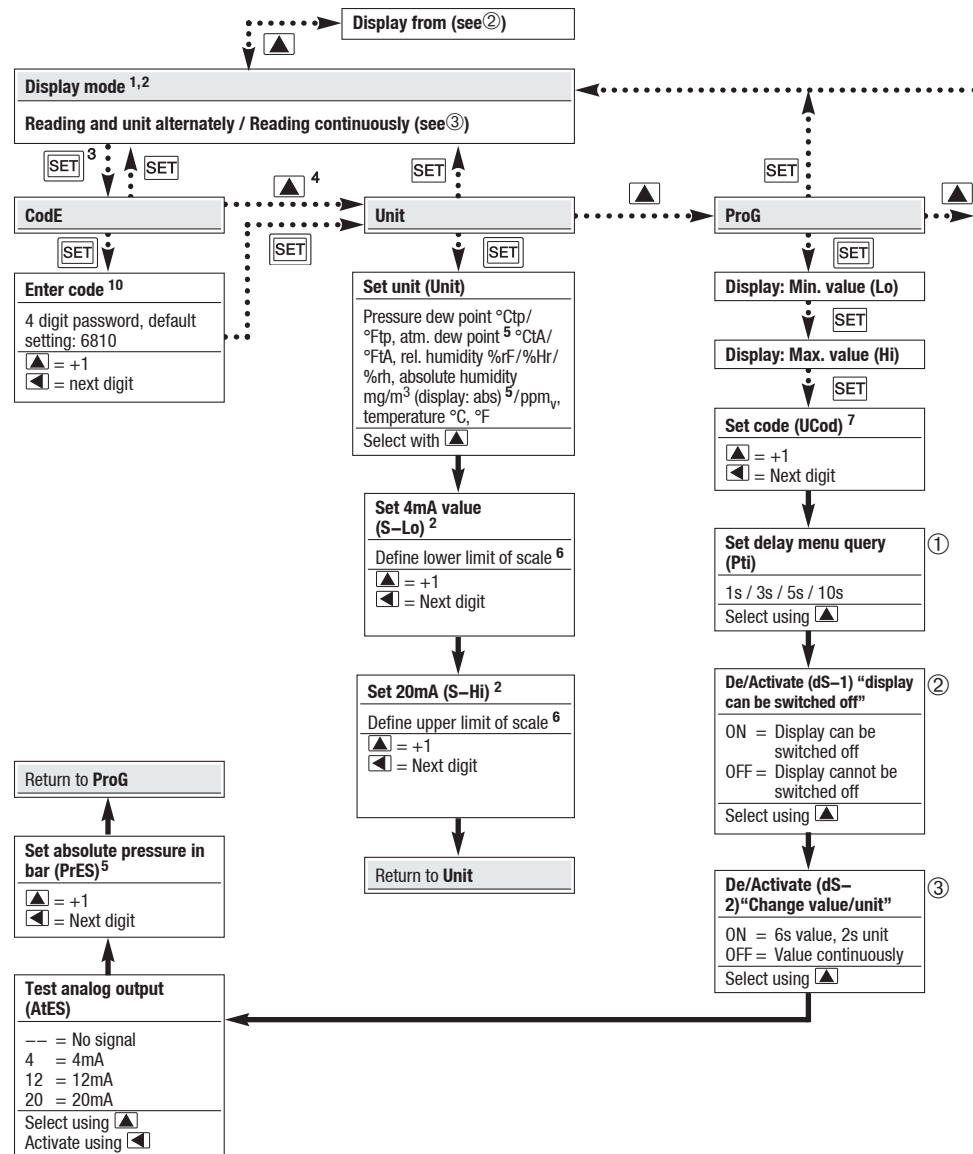

Max. circuit:
30VDC/ 0.5A

5. Menu guide (0555.6743/0555.6744 only)



Signs and symbols:

-  Press button briefly.
-  Keep button pressed for 2s.
-  Change menu using button specified.
-  Save input using  and change menu **or** change menu using  without saving input.

Notes:

- 1 If there are breaks in the input, the system returns automatically to the display mode after approx. 1min.
- 2 In the case of the units ppm and Abs (mg/m3), values are displayed/entered to the power of ten. Examples:
15E1 corresponds to $15 \times 10 = 150$, 02E2 corresponds to $2 \times 100 = 200$, 21E3 corresponds to $21 \times 1000 = 21000$
- 3 Keep button pressed (1s/3s/5s/10s, corresponding to setting in ①, default setting: 5s).
- 4 Only with deactivated code (can be set in Prog - UCode menu).
- 5 Absolute pressure (can be set in Prog - Pres menu) is included in the calculation for absolute humidity (Abs) and atmospheric dew point ($^{\circ}\text{Ctp}/^{\circ}\text{Ftp}$).
- 6 For negative values: select "-" at left digit position.
- 7 To deactivate codes: Enter 0000.
- 8 Can only be used together with the 0554.3302 plug.
- 9 Menu is only available if one of the following units is set: $^{\circ}\text{Ctp}$, $^{\circ}\text{Ftp}$, %F, %Hr or %rh (can be set in Unit menu). Also see 6. Adjustment on site, p. 16.
- 10 General password (always valid): 6810

6. Adjustment on site

One point adjustment by inputting one reference value

Using one point adjustment, you can enter a reference value for a working point (e.g. -10°Ctpd) specified by you. In this way you will achieve a minimum target/actual deviation from this working point.

As a reference, you will need a dew point mirror or a reference measuring instrument (e.g. testo 400, testo 650) with a pressure dew point probe.

! The **Adj** menu in which the reference value is entered is only available if one of the following units is set: $^{\circ}\text{Ctp}$, $^{\circ}\text{Ftp}$, $\%rF$, $\%Hr$ or $\%rh$ (See 5. Menu guide, p. 14, Unit menu, Setting unit).

- 1 Expose reference measuring instrument and testo 6740 to identical, constant conditions and await adjustment time.
- 2 Measure reference value and compare with testo 6740 reading.
- 3 If there are deviations in the values, enter reference value in **Adj** menu.

7. Care and Maintenance

Filter, measurement chamber, cooling coil

If process conditions are oily or dusty, the stainless steel sintered filter should be cleaned and also the measurement chamber and cooling coil should be cleaned if used.

- Unscrew/remove filter, measurement chamber and cooling coil, purge with compressed air or place in an ultrasonic bath.

Sensor cleaning

- Unscrew the filter and rinse the sensor carefully with water or ethanole. Let dry well.



8. Troubleshooting

Fault	Possible causes	Remedy
Analog output values too low/too high	– Incorrect scaling or unit	► Change scaling or unit in Unit menu
No signal	– Connection interrupted or – Supply voltage too low – Polarity incorrect	► Check cables ► Check power: Standard plug min. 12VDC 0554.3302 plug: min. 20VDC
Signal >21mA	– Sensor defect (broken).	Sensor must be replaced. ► Contact your local distributor or Testo's Customer Service.
Signal <4mA	– Sensor corroded	Sensor must be replaced. ► Contact your local distributor or Testo's Customer Service.
Display "oF"	– No signal from sensor	► Contact your local distributor or Testo's Customer Service.

If the fault cannot be repaired by following the suggestions given in the above table, please contact your local distributor or Testo's Customer service department.

9. Technical data

9.1 Measurement ranges and accuracies

Type of measurement	Measurement range	Accuracy
Pressure dew point temperature (trace humidity)	–60 to +30°Ctpd	±1 K at ±0°Ctp ±3 K at –20°Ctp ±4 K at –40°Ctp (at 25°C)
atm. dew point	–80 to –15°Ctd at 30 bar _{rel} –70 to +10°Ctd at 3 bar _{rel} –60 to +30°Ctd at 0 bar _{rel}	cf. pressure dew point temperature
Temperature	±0 to +50°C	±0.5 K

9.2 Additional instrument data

Characteristic	Values
Supply voltage	24VDC (standard plug: 12 to 30VDC allowed, 0554.3302 plug: 20 to 28VDC allowed)
Max. load	Standard plug: 12V: 50 Ohm, 24V: 650 Ohm, 30V: 950 Ohm 0554.3302 plug: 12V: not allowed, 24V: 650 Ohm, 30V: not allowed
Ambient temperature	–20 to +70°C
Storage/transport temperature	–20 to +80°C
Protection class	IP65 (with plug attached and cable connected)
Rotatability (display alignment)	350°
Humidity sensor	Testo humidity sensor with logged trace humidity—adjustment at –40°Ctp/6 bar
Temperature sensor	NTC
Sensor protection	Stainless steel sintered cap
Pressure resistance	–1 bar _{rel} to +50 bar _{abs} Measurement chamber 0554.3303: max. 15 bar _{abs}
Dimensions	199.5x37x37 (with standard plug), 203.5x37x37 (with 0554.3302 plug)
Analog output	
Signal	4 to 20mA, two-wire technology
Scaling	Standard: 4 to 20mA = –60 to +30°Ctpd, with freely scalable display
Output parameters	°Ctp, °Ftp, °CtA, °FtA, %RH, ppm _v , mg/m ³ , °C, °F
Resolution	12 bit
Accuracy	±40µA
Limit value outputs (optional, only with 0554.3302 plug)	
Contacts	2 NO contacts, potential-free, max. circuit 30V/0.5A
Operating points:	Standard: +4°Ctp/12°Ctp, freely programmable with display

10. Accessories/Spare parts

Name	Part no.
Basic instruments (incl. plug for analog signal output)	
with process connection G1/2, without display	0555 6741
with process connection NPT1/2", without display	0555 6742
with process connection G1/2, with display	0555 6743
with process connection NPT1/2", with display	0555 6744
Accessories	
Cable connection plug for power/analog output 4 to 20 mA, with 2 floating switch contacts and 2 LEDs (limit signal output, alarm output)	0554 3302
Measurement chamber for optimum flow on humidity sensor, max. 15 bar, for thread G1/2	0554 3303
Cooling coil for process temperatures above 50 °C (up to 200 °C)	0554 3304
ISO calibration certificate for pressure dew point (–40° to 0° Ctp at 6 bar), free choice of points	0520 0116
ISO calibration certificate for pressure dew point at –10° Ctp and –40° Ctp	0520 0136

Warranty

Testo grants a warranty of 2 years from the date of the initial purchase for this product. The warranty covers all material and manufacturer faults.

Faults occurring during the warranty time will be rectified by Testo AG, its authorised sales subsidiaries or authorised dealers in accordance with the following conditions and without charge for labour and material costs.

Either the defective components will be replaced with new spare parts or the entire product will be replaced according to Testo's estimation.

The following are excluded from the manufacturer's warranty:

Wear parts (e.g. rechargeable batteries/batteries, printing mechanisms) and consumables (e.g. printer paper).

- Damage caused by:
 - use contrary to the intended purpose or failure to observe the instruction manual and/or the safety instructions,
 - lack of care, accidents or normal wear,
 - external influences (e.g. damage during transport, damage caused by vibration, excess heat, water, moisture or acids),
 - use of unsuitable accessories.

This warranty expires if:

- the type or serial number of the product is changed, deleted, removed or made illegible
- repairs or modifications are undertaken by third parties or unauthorised persons.

This warranty covers none of the following items:

- regular maintenance and repairs or the replacement of parts due to normal wear,
- the costs of packaging and transport,
- transport risks incurred directly or indirectly in connection with this warranty,
- the costs of repairs, adjustments or similar measures taken beyond the extent of this warranty.

In the case of a warranty claim, consult your dealer or the sales subsidiary responsible for your country. The addresses can be seen at www.testo.com.

Enclose a brief description of the fault and the purchase receipt, indicating the delivery and purchase dates, together with the product. Please also give us your telephone number for any inquiries.

Warranty repairs do not extend the period of warranty.

Further claims of any kind against Testo such as commercial transformation, price reduction or compensation will not be processed.



22 Customer service/Calibration service

Please contact your nearest Testo office or distributor for more information.

Notes 23

Notes section with 20 horizontal lines for writing.



ALGERIA
SNC COVAM
Bejaia 06000
Tel.: 34 20 76 23
Fax 34 20 76 23
covam_berri@yahoo.fr

ARGENTINA
Testo Argentina S.A.
C1440ACR - Buenos Aires
Tel. (11) 46 83 - 50 50
Fax (11) 46 83 - 50 50
info@testo.com.ar

ASIA
Testo (Asia) Ltd.
Shatin, N. T., Hong Kong
Tel. (2) 26 36 38 00
Fax (2) 26 47 23 39
testo@testo.com.hk

AUSTRALIA
Testo Pty. Ltd.
Wantirna 3152
Tel. (3) 98 00 43 99
Fax (3) 98 00 46 99
info@testo.com.au

AUSTRIA
Testo Ges. mbH
1170 Wien
Tel. (1) 4 86 26 11- 0
Fax (1) 4 86 26 11 20
info@testo.at

BELGIUM / LUXEMBURG
S. A. Testo N. V.
1741 Ternat
Tel. (2) 5 82 03 61
Fax (2) 5 82 62 13
info@testo.be

BOLIVIA
T.E.C.
Cochabamba
Tel. (4) 4 00 09 17
Fax (4) 4 28 60 02
tec@supernet.com.bo

Helios SRL
Santa Cruz
Tel. (3) 49 26 03
Fax (3) 12 57 45
helios@infonet.com.bo

BOSNIA-HERZOGOWINA
Tehnounion Sarajevo
Sarajevo
Tel. (33) 20 59 44
Fax (33) 44 40 00

BRAZIL
Testo do Brazil
13028-015 Campinas - SP
Tel. (19) 37 31 - 58 00
Fax (19) 37 31 - 58 19
testo@testo.com.br

BULGARIA
Global Test OOD
1408 Sofia
Tel. (2) 9 53 07 96,
Fax (2) 9 52 51 95
gbl_tst@sps.bg

CHILE
ANWO S.A.
Santiago
Tel. (2) 7 31 00 00
Fax (2) 7 31 04 04
instrumentos@anwo.cl

CHINA
Testo Instruments International
Trading (Shanghai) Co., Ltd.
Shanghai 200031
Tel. (21) 54 56 - 14 48
Fax (21) 54 56 - 14 70
testosales@testo.com.cn

CIS
Global Export GmbH
105 023 Moscow
Tel. (0 95) 3 60 53 68
Fax (0 95) 3 60 53 68
global_export@aport2000.ru

COLOMBIA
Arotec Colombiana S. A.
Bogota D. E.
Tel. (1) 2 88 77 99
Fax (1) 2 85 36 04
mantenimiento@arotec.net

COSTA RICA
Representaciones
Corelsa S. A.
Santo Domingo de Heredia
Tel. 2 44 25 50
Fax 2 44 30 90
corelsa@racsa.co.cr

CROATIA
"H.I.P." Zagreb d.o.o.
10090 Zagreb
Tel. (1) 3 73 40 07
Fax (1) 3 73 40 44
hip@inet.hr

CYPRUS
Deksa Ltd.
Nicosia
Tel. (2) 2 45 55 55
Fax (2) 2 49 70 59
deksta@cytanet.com.cy

CZECH REPUBLIC
Testo s.r.o.
158 00 Praha 5
Tel. (2) 57 29 02 05
Fax (2) 57 29 04 10
info@testo.cz

DENMARK
Buhl & Bonsoe A/S
2830 Virum
Tel. 45 95 04 10
Fax 45 95 04 12
inf@buhl-bonsoe.dk

EGYPT
Future Plants Contractors
Heliopolis 11361, Cairo
Tel. (2) 4 18 67 79
Fax (2) 4 18 95 04
future98@intouch.com

EL SALVADOR
Eco Control S.A. de C.V.
San Salvador
Tel. 2 60 66 01
Fax 2 60 66 02
eco.control@sv.intercomnet.net

FINLAND
Humitec Oy
00300 Helsinki
Tel. (9) 5 30 84 00
Fax (9) 53 08 40 99
testo@humitec.fi

FRANCE
testo Sàrl
57602 Forbach
Tel. 3 87 29 29 00
Fax 3 87 87 40 79
info@testo.fr

GREECE
Sigma Hellas Ltd.
18536 Piraeus
Tel. (210) 4 52 27 45
Fax (210) 4 51 90 20
sales@sigmahellas.gr

Sigma Hellas Ltd.
54644 Thessaloniki
Tel. (23 10) 98 80 40
Fax (23 10) 98 92 72
sigmaweb@hol.gr

GREAT BRITAIN / IRELAND
Testo Ltd.
Alton, Hampshire GU34 2QU
Tel. (14 20) 54 44 33
Fax (14 20) 54 44 34
info@testo.co.uk

HUNGARY
Testo Kft.
1139 Budapest
Tel. 237 17 47
Fax 237 17 48
testo@testo.hu

ICELAND
Rafn Jensson, Mechanical
Engineers ehf
110 Reykjavik
Tel. 5 67 80 30
Fax 5 67 80 15
rj@rj.is

INDIA
Siskin Instruments Co. Ltd.
Bangalore 560 054
Tel. (80) 3 60 25 60
Fax (80) 3 60 36 79
siskin@eth.net

WAAREE Instruments Ltd.
Mumbai 400 093
Tel. (22) 26 87 47 78
Tel. (22) 26 87 36 13
waaree@waaree.com
belha3@caramail.com

IRAN
Mehr Kanaz Sanat Co.
Tehran
Tel. (21) 2 26 26 89
Fax (21) 2 22 37 77
info@mehr-kanaz.com

ISRAEL
Manoraz Ltd.
Azur 58001
Tel. (3) 5 59 33 99
Fax (3) 5 58 44 95
david@manoraz.com

ITALY
Testo S.p.A.
20019 Settimo Milanese (Mi)
Tel. (02) 3 35 19 - 1
Fax (02) 3 35 19 - 200
info@testo.it

JAPAN
Testo K.K.
Yokohama 222-0033
Tel. (45) 4 76 22 88
Fax (45) 4 76 22 77
info@testo.co.jp

JORDAN
Al-Masar Technique Est.
Sahab 115-12
Tel. (6) 4 02 95 22
Fax (6) 4 02 35 64
masar@joinet.com.jo

KOREA (Republic of)
Testo (Korea) Ltd.
Seoul 150-102
Tel. (2) 26 72 72 00
Fax (2) 26 79 98 53
testo@testo.co.kr

MALTA
Technoline Ltd.
Gzira GZR 06
Tel. (21) 34 23 66
Fax (21) 34 39 52
admin@technoline-mt.com

MACEDONIA
Pharmachem Skopje
1060 Skopje
Tel. (2) 33 11 93
Fax (2) 33 14 34
farmahem@mt.net.mk

MEXICO
Grupo de Instrumentación y
Medición Industrial de México,
S.A. de C.V.
08920 Mexico, D.F.
Tel. (55) 56 34 04 02
Fax (55) 56 33 04 01
scc@gimin.com

MOROCCO
A.F.M.I.L. SARL
Belevedere-Casablanca
Tel. (22) 24 01 84
Fax (22) 24 01 87
Belha3@caramail.com

NETHERLANDS
Testo B.V.
1314 BH Almere-Stad
Tel. (36) 5 48 70 00
Fax (36) 5 48 70 09
info@testo.nl

NEW ZEALAND
Eurotec Instruments Ltd.
Auckland
Tel. (9) 5 79 19 90
Fax (9) 5 25 33 34
cfarmer@eurotec.co.nz

NICARAGUA
Adolfo Gröber & Cía Ltda.
Managua
Tel. 2 66 51 36
Fax 2 66 51 39
agroeber@cablenet.com.ni

NORWAY
Max Sievert A/S
0134 Oslo
Tel. (22) 17 30 85
Fax (22) 17 25 11
firmapost@maxsievert.no

PERU
JUL Asociados S.A.
Lima 17
Tel. (1) 2 61 17 52
Fax (1) 2 61 46 07
jllasociados@hotmail.com

PHILIPPINES
Keystone Industrial
Trading Corporation
Pasay City 1300,
Tel. (2) 8 31 95 71
Fax (2) 8 31 40 13
keystone@globenet.com.ph

POLAND
Testo Sp. z o.o.
02-362 Warszawa
Tel. (22) 8 63 74 22
Fax (22) 8 63 74 15
testo@testo.com.pl

PORTUGAL
Testo Portugal Lda.
3830-237 Ribas (ILHAVO)
Tel. 2 34 08 37 11
Fax 2 34 08 37 08
testo@netvisao.pt

ROMANIA
Test Line SRL
72217 Bucharest
Tel. (21) 6 87 34 62
Fax (21) 2 42 68 24
testline@customers.digiro.net

SERBIA
YMC Laboratorija
1100 Belgrade
Tel. 11 316 2335
Fax 11 316 2587
ymclab@verat.net

SINGAPORE / MALAYSIA / INDONESIA
Futron Electronics PTE LTD
Singapore 329 714
Tel. (65) 62 50 24 56
Fax (65) 62 50 65 92
futron@cyberway.com.sg

SLOVAKIA
K - Test s.r.o.
042 60 Kosice
Tel. (1) 55 625 36 33
Fax (1) 55 625 36 33
ktest@kbc.sk

SLOVENIA
Komplast d.o.o.
1356 Dobrova
Tel. (1) 5 44 11 30
Fax (1) 5 44 11 31
komplast2@mrak.si

SOUTH AFRICA
Unitemp
Landsdowne, Cape Town,
7779
Tel. (21) 7 62 89 95
Fax (21) 7 62 89 96
info@unitemp.com

SPAIN
Instrumentos Testo S. A.
08348 Cabriels (Barcelona)
Tel. (93) 753 95 20
Fax (93) 753 95 26
info@testo.es

SWEDEN
Nordtec Instrument
40241 Göteborg
Tel. (31) 7 04 10 70
Fax (31) 12 50 42
nordtec@nordtec.se

SWITZERLAND
Testo AG
8604 Volketswil
Tel. (1) 9 08 40 50
Fax (1) 9 08 40 51
info@testo.ch

SYRIA
Medical Business Center
Damascus
Tel. (11) 2 32 23 01
Fax (11) 2 32 23 02
bahah@net.sy

TAIWAN, R.O.C.
Hot Instruments Co. Ltd.
Chungho City, 235
Tel. (2) 89 23 23 18
Fax (2) 89 23 23 17
info@testoag.com.tw

THAILAND
Entech Associate Co. Ltd.
Bangkok 10210
Tel. (2) 9 54 54 99
Fax (2) 9 54 54 95
info@entech.co.th

TUNISIA
Starepr
2000 Le Bardo
Tel. (71) 50 92 86
Fax (71) 58 49 20
afri.sta@gnet.tn

TURKEY
Testo Elektronik ve Test Ölçüm
Cihazları Dis Ticaret Ltd. STi
80290 Gayrettepe-Istanbul
Tel. (212) 2 17 01 55
Fax (212) 2 17 02 21
info@testo.com.tr

UNITED ARAB EMIRATES
Enviro engineering (W.L.L.)
General Trading
Dubai
Tel. (14) 2 27 70 20
Fax (14) 2 23 36 83
envireng@emirates.net.ae

USA
Testo Inc.
Flanders, NJ 07836
Tel. (973) 2 52 17 20
Fax (973) 2 52 17 29
info@testo.com

VENEZUELA
G & M International Service,
C. A.
San Antonio de los Altos,
Edo. Miranda
Tel. (2) 3 72 77 70
Fax (245) 5 71 67 74
gminter@cantv.net

Sermatic srl
Carabobo
Tel. (45) 71 36 35
Fax (45) 71 36 35
nugece@cantv.net

VIETNAM
MTC
Measuring and Testing
Equipment Company Ltd.
Hanoi
Tel. (4) 7 33 36 36
Fax (4) 7 33 21 03
mtc-hn@hn.vnn.vn

SMICO
Scientific Equipment &
Measuring and Testing
Hanoi
Tel. (4) 8 53 26 92
Fax (4) 5 63 77 36
smico@fpt.vn

Stand: 03.06.2003
Stets aktualisierte Adressdaten
unserer Töchter und Landes-
Vertriebspartner finden Sie im
Internet unter: www.testo.com

03.06.2003
The most up-to-date address
details of our subsidiaries and
agencies can be found in
Internet at: www.testo.com



testo
